

QEF 300 AEROFOIL CABLE SUPPORT BRISE SOLEIL

AEROFOIL BLADE PITCHED AT 280mm CENTRES
TO PREVENT INGRESS OF SUNLIGHT TO A
MAXIMUM ANGLE OF 62° FROM THE HORIZONTAL

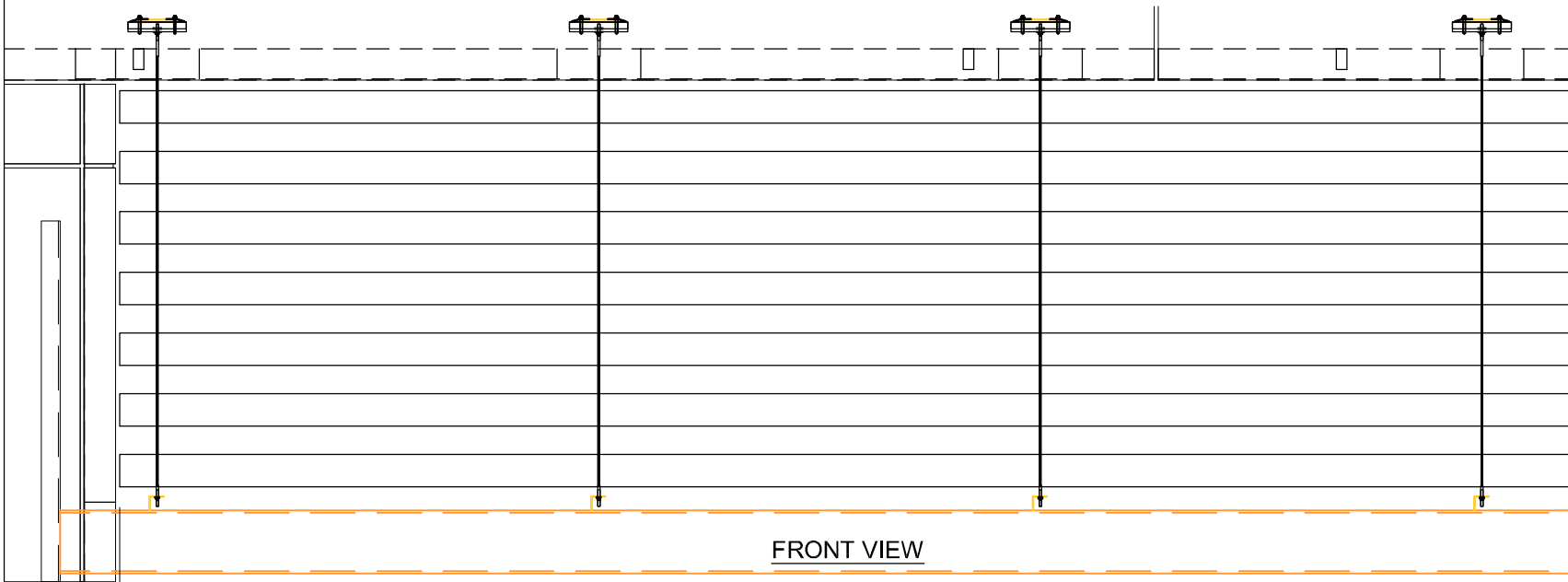

Specification

Manufacturer and reference: QEF 300
Aerofoil Brise Soleil system supplied and installed by QEF Ltd.
Tel: +353 (0)56 776 4910
Fax: +353 (0)56 776 1557.

Description: Extruded Aluminium Aerofoil, 300mm wide fixed with a stainless steel cable support system.

Blade Pitch: 280mm @ 30° angle.

Material: System manufactured from extruded aluminium alloy 6063 T6.

Finish: Polyester powder coated to RAL, BS colour, or Decoral Timber Effect finish.

Dimensions: As shown on drawings. Max span between cables dependant upon loading requirements. Bespoke support system and blade orientation can be contract specific - customer must specify requirement.

Performance: Direct sunlight to be eliminated through the Brise Soleil up to 62°.

Fixing: To subcontractors details. A wide range of stainless, galvanised steel or aluminium fixing brackets, including steel, block & curtain walling.

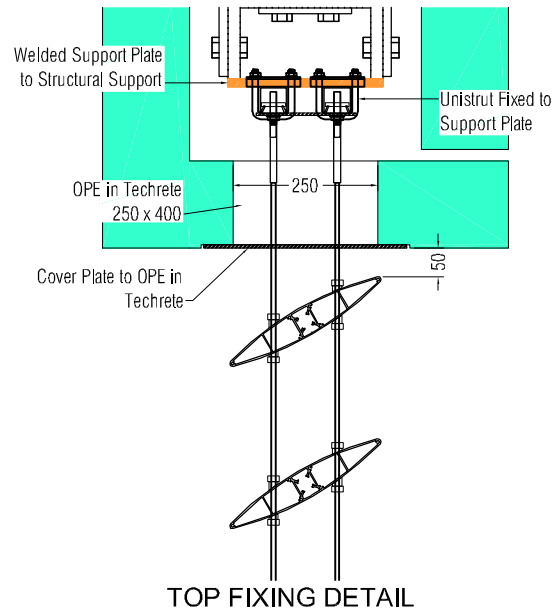

TOP FIXING DETAIL

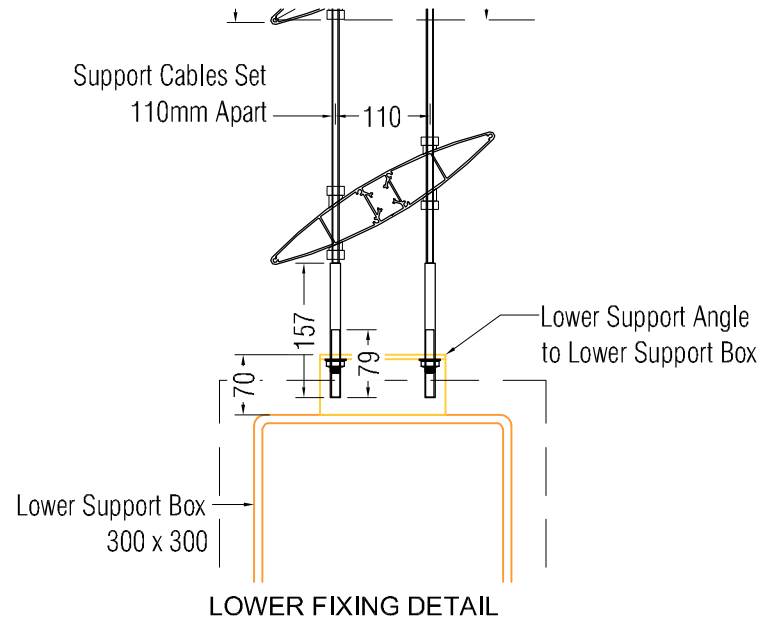

LOWER FIXING DETAIL



Commercial Centre
Dublin Road
Kilkenny
Tel: +353 (0)56 776 4910
Fax: +353 (0)56 776 1557
Website: www.qefltd.ie
Email: sales@qefltd.ie

Drawn:	Date:	Scale:
RAB	14/04/16	NTS
Drawn:	Rev:	
A300/V/CS	-	