

# QEF CEDAR 140x30 CANTILEVER SIDE ARM BRISE SOLEIL

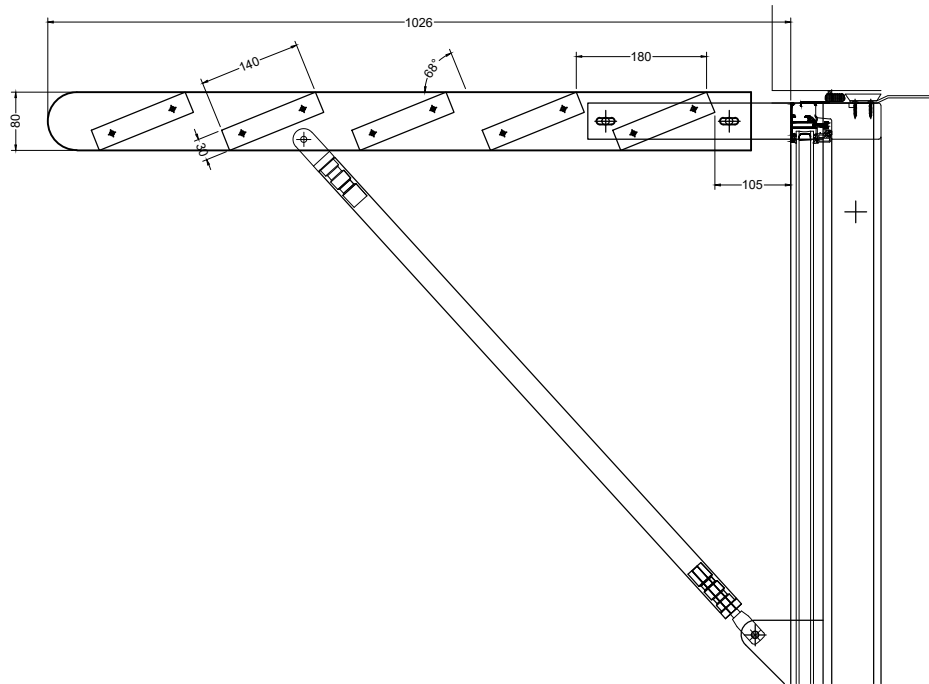

SIDE VIEW WITH STRUT

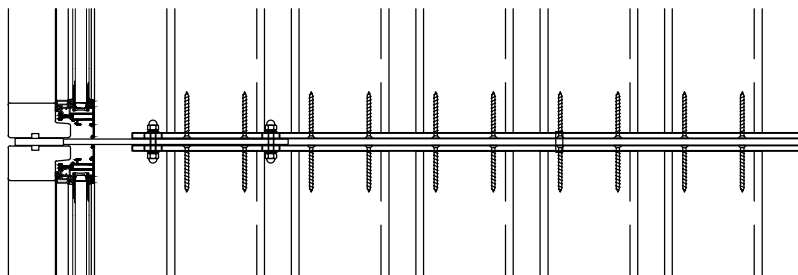
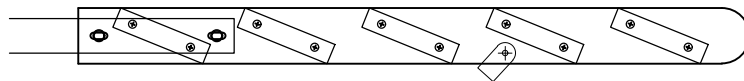

CEDAR PLANK FIXING DETAILS

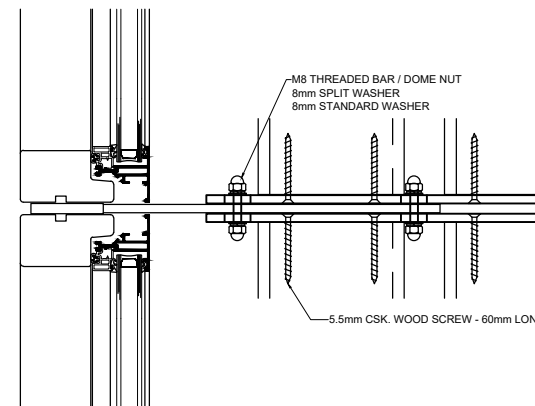

BRACKET FIXING DETAILS

## Specification

**Manufacturer and reference:** QEF 140x30  
Western Red Cedar Brise Soleil system supplied and installed by QEF Ltd.  
Tel: +353 (0)56 776 4910  
Fax: +353 (0)56 776 1557.

**Description:** Machined 140x30 Western Red Cedar Plank Brise Soleil system mounted on Side Arm with strut support.

**Blade Pitch:** To clients specification.

**Material:** All aluminium manufactured from extruded aluminium alloy 6063 T6.

**Finish:** Western Red Cedar self finish, Extruded aluminium polyester powder coated to RAL or BS colour.

**Dimensions:** As shown on drawings. Max span between mullions dependant upon loading requirements. Bespoke blade orientation can be contract specific - customer must specify requirement.

**Fixing:** To subcontractors details. A wide range of stainless, galvanised steel or aluminium fixing brackets is available for different fixing grounds, including steel, block & curtain walling.



Commercial Centre  
Dublin Road  
Kilkenny

Tel: +353 (0)56 776 4910  
Fax: +353 (0)56 776 1557  
Website: www.qefltd.ie  
Email: sales@qefltd.ie

Drawn:	Date:	Scale:
RAB	14/04/16	NTS
Dwg.No.:	Rev.:	
BS/CED/H/SAS		