

QEF CEDAR 200x50 SIDE ARM SECRET FIX BRISE SOLEIL

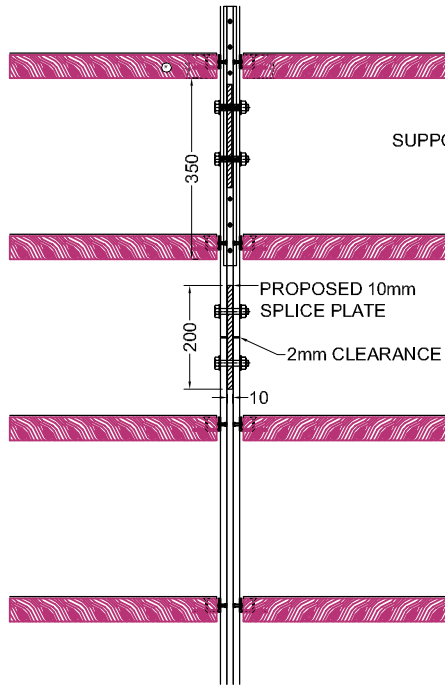

TYPICAL SECTION DETAILS



FRONT & SIDE VIEWS

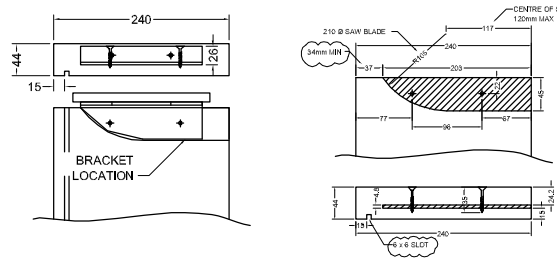
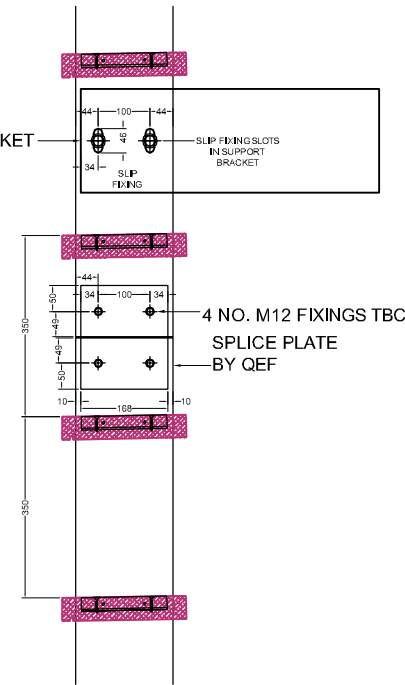

4.8 mm SLOT DETAIL AND SCREW HOLE DETAILS

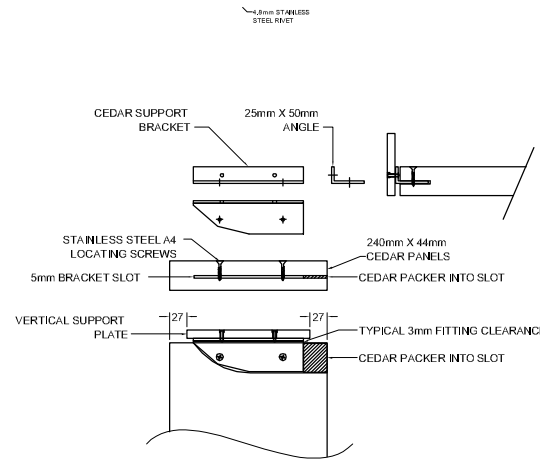

SECRET FIX DETAILS

Specification

Manufacturer and reference: QEF 200x50 Western Red Cedar Brise Soleil system supplied and installed by QEF Ltd.
Tel: +353 (0)56 776 4910
Fax: +353 (0)56 776 1557.

Description: Machined 200x50 Western Red Cedar Plank Brise Soleil system mounted on Side Arm with secret fix detail.

Blade Pitch: To clients specification.

Material: All aluminium manufactured from extruded aluminium alloy 6063 T6.

Finish: Western Red Cedar self finish, Extruded aluminium polyester powder coated to RAL or BS colour.

Dimensions: As shown on drawings. Max span between mullions dependant upon loading requirements. Bespoke blade orientation can be contract specific - customer must specify requirement.

Fixing: To subcontractors details. A wide range of stainless, galvanised steel or aluminium fixing brackets is available for different fixing grounds, including steel, block & curtain walling.



Commercial Centre
Dublin Road
Kilkenny
Tel: +353 (0)56 776 4910
Fax: +353 (0)56 776 1557
Website: www.qefltd.ie
Email: sales@qefltd.ie

Drawn:	Date:	Scale:
RAB	14/04/16	NTS
Drawn No:	BS/CED/V/SA	Rev: